



Accessories

10048500-Draw-Wire-WDS-1900-Z60-M(07)



General Data

| | |
|---------------------------------|---|
| Intro | Draw Wires or Cable Pull adapters when combined with encoders enable to measure the linear position accurately and also communicate the position over the interface of your choice. All POSITAL draw wire adapters use a stainless steel measuring wire |
| Flange Type | Synchro - Solid Shaft |
| Flange Diameter | 58 mm |
| Accuracy | ± 0.02 % FSO |
| Repeatability | ± 0.006 % FSO |
| Measurement Length | 1.90 m (6.23') |
| Draw Wire Enclosure | Draw Wire Enclosure#Machined Metal#Cylindrical Housing |
| Draw Wire Housing Material | Aluminum |
| Wire Material | Coated Polyamide Stainless Steel |
| Wire Diameter | 0.45 mm |
| Length per Revolution | 150 mm |
| Max. Speed of Wire Displacement | 2.0 m / s |
| Max Extension Force | 5.0 N |
| Max. Angular Acceleration | 12.0 g |
| Min Retraction Force | 3.5 N |
| Wire Mounting | Eyelet |

Data Sheet

Printed at 13-06-2023 07:06



| | |
|----------------------|------|
| Shaft Diameter | 6 mm |
| Max. Wire Exit Angle | ±3° |

Mechanical Data

| | |
|-----------------------|-------------------------------|
| Operating Temperature | -20°C to 80°C / -4°F to 176°F |
| Weight | 200 g |

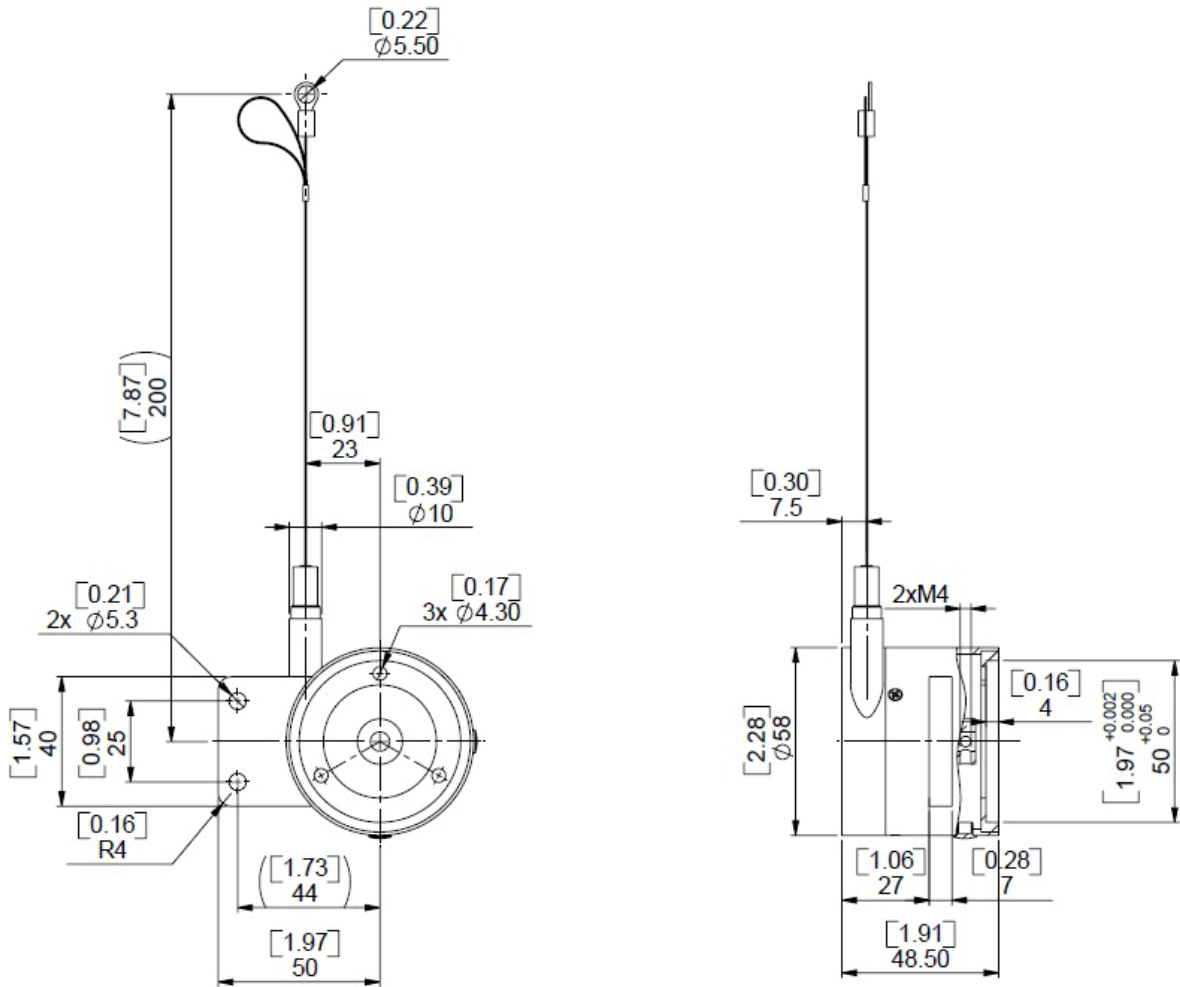
Contact



Contact Us

All dimension in [inch] mm. This drawing and the information contained is for general presentation purposes only. Please refer to the "Download" section for detailed technical drawings. © FRABA B.V., All rights reserved. We do not assume responsibility for technical inaccuracies or omissions. Specifications are subject to change without notice.