

- Measuring length 50 - 1000 mm
- 16 bit resolution
- Excellent movement with ROD design
- Single - double output options
- Ball joints on the both sides

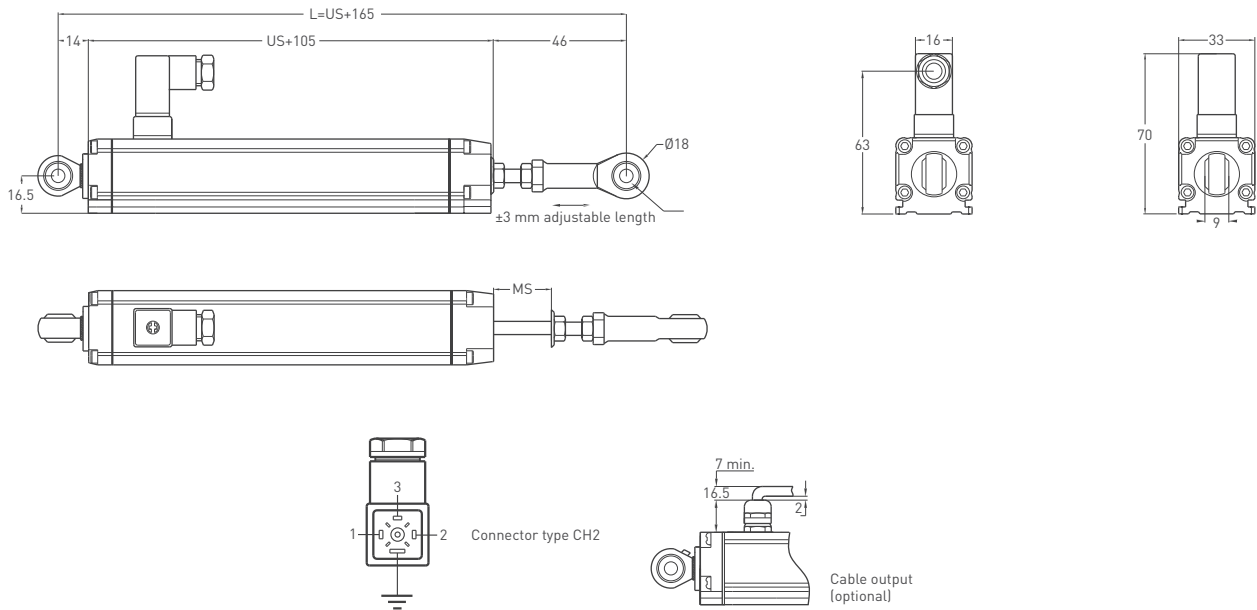

Technical Specifications	
Measurement stroke	50 to 1000 mm
Resolution	16 bit DAC output
Linearity	±0,05% full scale (min. 100 µm)
Repeatability	100 µm
Output	0-10V, 10-0V, 0-20 mA, 20-0 mA, 4-20 mA, 20-4 mA
Power supply	24 VDC ±10%
Displacement speed	max. < 5 m/s
Update time	(0-600mm, 0,5ms) , (601-1000mm, 1ms)
Max. consumption	50 mA - 90 mA (depending on stroke length)
Max. output noise	< 5 mVpp
Max. output value	10,5 V
Reverse polarity protection	Up to -30 VDC
Overvoltage protection	Up to +30 VDC
Vibration	EN 60068-2-6 , 5-200 Hz 200 m/s ² (20g) , 2h 30min each axis (x,y,z)
Shock	EN 60068-2-2:2007 500 m/s ² (50g) , 11ms. (x,y,z axis)
Case dimensions	33 mm x 33 mm
Case material	Anodized aluminium
Rod material	Stainless steel
Rod diameter	Ø6 mm
Mechanical fixing	Ball joints on the both sides
Protection level	IP 65
Operating temperature	-10°C ... +70°C
Storage temperature	-30°C ... +90°C

Mechanical Specifications



MSRM (mm)	50	100	150	200	250	300	350	400	450	500	550	600	650	700	750	800	850	900	1000
ML (Measuring Length)	50	100	150	200	250	300	350	400	450	500	550	600	650	700	750	800	850	900	1000
L (Total Length)	310	360	410	460	510	560	610	660	710	760	810	860	910	960	980	1060	1110	1160	1260

Round Connector

5 pin Connector configuration

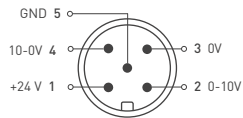

CN5 M12 (A) / M16 (B)
5 pin

6 pin Connector configuration

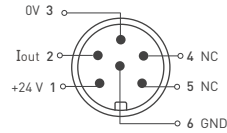

CN6 M12 (A) / M16 (B)
6 pin

8 pin Connector configuration

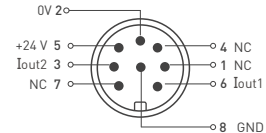

CN8 M12 (A) / M16 (B)
8 pin

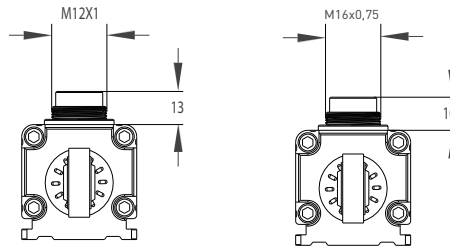

Hydraulic Type Connector

CH2

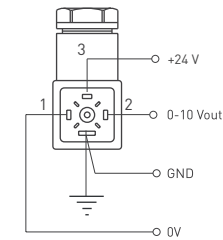

0-10V or 10-0V Output

CH2

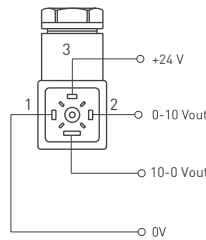

0-10V and 10-0V Output

CH2

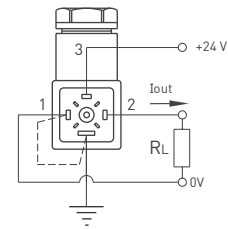

0-20mA or 4-20mA Output

Cable

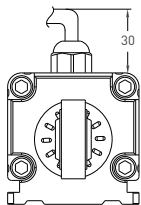

Voltage Output

+V : Brown
0V : Blue
0V Sense : Black
Output 1 : White (0-10V)
Output 2 : Orange (10-0V)
Earth : Shield

Current Output

+V : Brown
0V : Blue
0V Sense : Black
Output 1 : White (Iout1)
Output 2 : Orange (Iout2)
Earth : Shield

Cable Length

1M : 1meter (standard)
(Different cable lengths available)

Ordering Procedure

Model	Measurement stroke	Resolution	Output	Connector / Cable
MSRM	300	A	V10	CH2
MSRM	50 - 1000 mm	A: 16 bit B: 15 bit C: 14 bit D: 13 bit E: 12 bit	V10 :0-10V I40 :4-20mA 2V10 :0-10V/0-10V 2I40 :4-20mA/4-20mA V01 :10-0V I04 :20-4mA 2V01 :10-0V/10-0V 2I04 :20-4mA/20-4mA V11 :0-10V/10-0V I41 :4-20mA/20-4mA V50 :0-5V I20 :0-20mA 2V50 :0-5V/0-5V 2I20 :0-20mA/0-20mA V05 :5-0V I02 :20-0mA 2V05 :5-0V/5-0V 2I02 :20-0mA/20-0mA V51 :0-5V/5-0V I21 :0-20mA/20-0mA	CH2: Hydraulic type CN5A: M12 CN5B: M16 CN6A: M12 CN6B: M16 CN8A: M12 CN8B: M16 1M: 1meter 2M5: 2,5 meters